

求積表

地番 1				
NO	Xn	Yn	Yn+1-Yn-1	Xn · (Yn+1-Yn-1)
K3	49764.544	-75089.458	-5.132	-255391.639808
PP9	49759.617	-75092.206	-4.721	-234915.151857
PP8	49764.227	-75094.179	-16.118	-802099.810786
PP7	49769.229	-75108.324	-4.751	-236453.606979
K10	49784.326	-75098.930	25.914	1290111.023964
K4	49780.306	-75082.410	11.856	590195.307936
K15	49770.366	-75087.074	-7.048	-350781.539568
合計				664.582902
合計面積				332.2914510
地積				332.29 m ²

地番 2				
NO	Xn	Yn	Yn+1-Yn-1	Xn · (Yn+1-Yn-1)
PP9	49759.617	-75092.206	0.137	6817.067529
PP5	49755.525	-75094.042	-4.048	-201410.365200
PP4	49750.594	-75096.254	-19.861	-988096.547434
K6	49756.836	-75113.903	-19.465	-968516.812740
K9	49757.342	-75115.719	-1.265	-62943.037630
B3	49758.227	-75115.168	1.101	54783.807927
B4	49759.112	-75114.618	6.232	310098.785984
P8	49768.245	-75108.936	6.294	313241.334030
PP7	49769.229	-75108.324	14.757	734444.512353
PP8	49764.227	-75094.179	16.118	802099.810786
合計				518.555605
合計面積				259.2778025
地積				259.27 m ²

地番 3				
NO	Xn	Yn	Yn+1-Yn-1	Xn · (Yn+1-Yn-1)
PP4	49750.594	-75096.254	11.525	573375.595850
PP3	49736.944	-75102.378	-23.679	-1177721.096976
K17	49743.153	-75119.933	-15.160	-754106.199480
K16	49748.269	-75117.538	6.030	299982.062070
K6	49756.836	-75113.903	21.284	1059024.497424
合計				554.858888
合計面積				277.4294440
地積				277.42 m ²

地番 4				
NO	Xn	Yn	Yn+1-Yn-1	Xn · (Yn+1-Yn-1)
PP10	49724.603	-75111.650	-21.547	-1071416.020841
K20	49730.554	-75128.570	-12.434	-618349.708436
S15	49738.913	-75124.084	7.277	361950.069901
K18	49743.490	-75121.293	4.151	206485.226990
K17	49743.153	-75119.933	18.915	940891.738995
PP3	49736.944	-75102.378	12.910	642103.947040
PP11	49726.589	-75107.023	-9.272	-461064.933208
合計				600.320441
合計面積				300.1602205
地積				300.16 m ²

地番 5 共有地				
NO	Xn	Yn	Yn+1-Yn-1	Xn · (Yn+1-Yn-1)
PP6	49753.402	-75089.411	-7.787	-387429.741374
PP5	49755.525	-75094.042	-2.795	-139066.692375
PP9	49759.617	-75092.206	4.584	228098.084328
K3	49764.544	-75089.458	5.881	292665.283264
K14	49762.410	-75086.325	3.203	159388.999230
K13	49760.287	-75086.255	-3.086	-153560.245682
合計				95.687391
合計面積				47.8436955
地積				47.84 m ²

地番 6 道路				
NO	Xn	Yn	Yn+1-Yn-1	Xn · (Yn+1-Yn-1)
K11	49721.801	-75103.681	-17.882	-889125.245482
PP10	49724.603	-75111.650	-3.342	-166179.623226
PP11	49726.589	-75107.023	9.272	461064.933208
PP3	49736.944	-75102.378	10.769	535617.149936
PP4	49750.594	-75096.254	8.336	414720.951584
PP5	49755.525	-75094.042	6.843	340477.057575
PP6	49753.402	-75089.411	0.274	13632.432148
K12	49743.896	-75093.768	-14.270	-709845.395920
合計				362.259823
合計面積				181.1299115
地積				181.12 m ²

総合計面積	1398.1325250 m ²
-------	-----------------------------

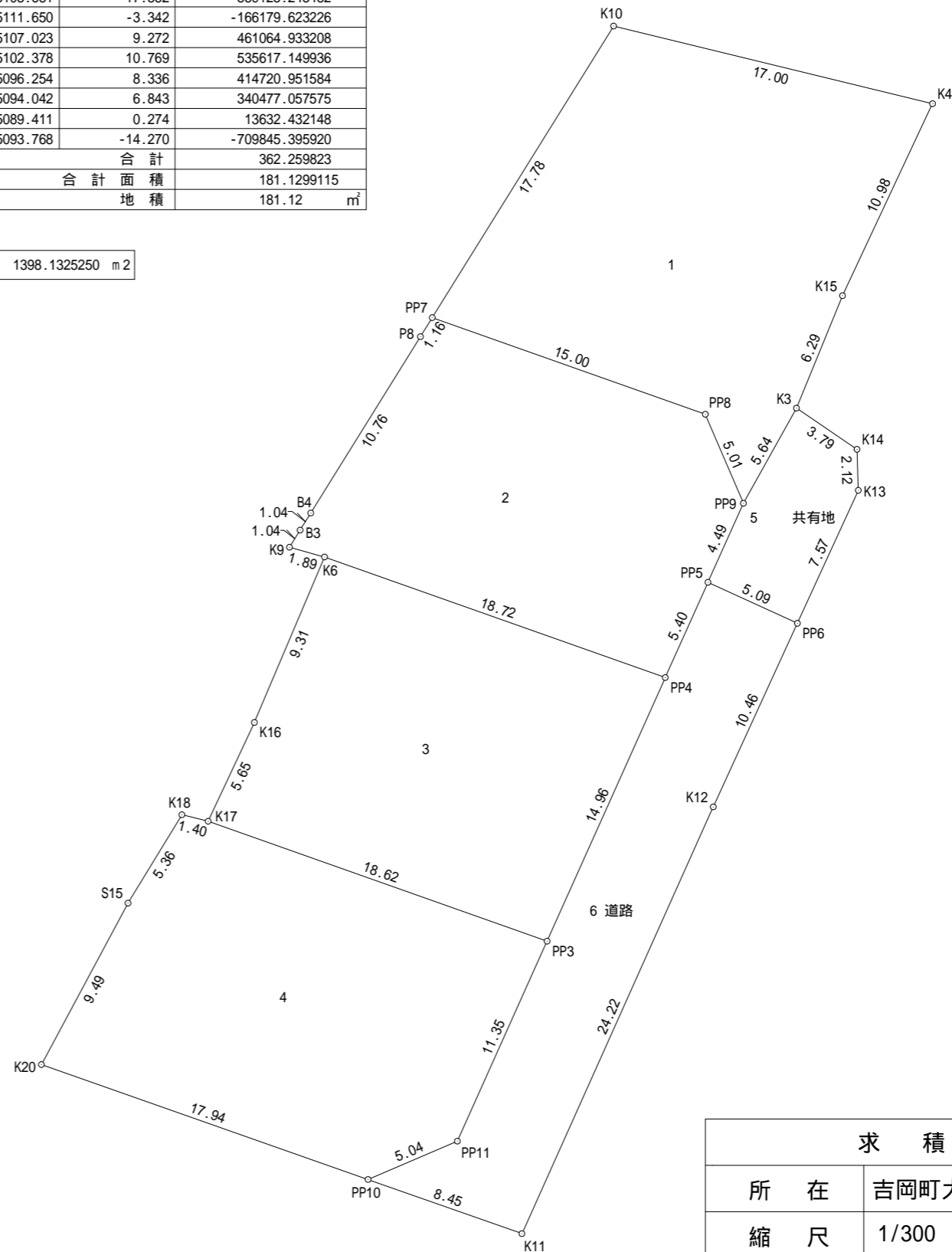

求積図	
所在	吉岡町大字北下字麻草原576
縮尺	1/300
作成日	令和6年6月4日
作成者	土地家屋調査士 須長 亮