

求積表

地番	1 -1			
N0	Xn	Yn	Yn+1-Yn-1	Xn · (Yn+1-Yn-1)
BP3	37423.335	-71560.553	-5.577	-208709.939295
BP2	37424.354	-71566.538	-8.788	-328885.222952
BP1	37424.984	-71569.341	-5.139	-192326.992776
1590	37430.157	-71571.677	-7.380	-276234.558660
P1	37442.719	-71576.721	6.877	257493.578563
P2	37445.721	-71564.800	14.226	532702.826946
1585	37436.551	-71562.495	3.839	143718.919289
1586	37429.343	-71560.961	1.942	72687.784106
合計				446.395221
合計面積				223.1976105
地積				223.19 m <sup>2</sup>

地番	2 -2			
N0	Xn	Yn	Yn+1-Yn-1	Xn · (Yn+1-Yn-1)
BP4	37422.882	-71558.648	-1.782	-66687.575724
BP3	37423.335	-71560.553	-2.313	-86560.173855
1586	37429.343	-71560.961	-1.942	-72687.784106
1585	37436.551	-71562.495	-3.839	-143718.919289
P2	37445.721	-71564.800	1.223	45796.116783
P3	37446.609	-71561.272	6.029	225765.605661
P4	37428.154	-71558.771	2.624	98211.476096
合計				118.745566
合計面積				59.3727830
地積				59.37 m <sup>2</sup>

地番	3 後退部			
N0	Xn	Yn	Yn+1-Yn-1	Xn · (Yn+1-Yn-1)
P6	37422.293	-71558.634	-1.881	-70391.333133
1587	37422.835	-71560.519	-8.004	-299532.371340
1588	37423.780	-71566.638	-8.568	-320646.947040
1589	37424.422	-71569.087	-2.703	-101158.212666
BP1	37424.984	-71569.341	2.549	95396.284216
BP2	37424.354	-71566.538	8.788	328885.222952
BP3	37423.335	-71560.553	7.890	295270.113150
BP4	37422.882	-71558.648	1.915	71664.819030
P5	37422.480	-71558.638	0.014	523.914720
合計				11.489889
合計面積				5.7449445
地積				5.74 m <sup>2</sup>

地番	4 -1			
N0	Xn	Yn	Yn+1-Yn-1	Xn · (Yn+1-Yn-1)
S5	37422.643	-71557.642	-0.875	-32744.812625
BP4	37422.882	-71558.648	-1.129	-42250.433778
P4	37428.154	-71558.771	-2.624	-98211.476096
P3	37446.609	-71561.272	-6.029	-225765.605661
P2	37445.721	-71564.800	-5.050	-189100.891050
1582	37451.776	-71566.322	17.400	651660.902400
1197	37456.880	-71547.400	25.450	953277.596000
1603	37457.350	-71540.872	8.602	322208.124700
1604	37439.625	-71538.798	-17.866	-668896.340250
1610	37435.355	-71558.738	-18.975	-710335.861125
1763	37428.233	-71557.773	1.096	41021.343368
合計				862.545883
合計面積				431.2729415
地積				431.27 m <sup>2</sup>

地番	5 -2			
N0	Xn	Yn	Yn+1-Yn-1	Xn · (Yn+1-Yn-1)
P1	37442.719	-71576.721	-14.272	-534382.485568
1583	37448.572	-71579.072	7.041	263675.395452
1584	37450.937	-71569.680	12.750	477499.446750
1582	37451.776	-71566.322	4.880	182764.666880
P2	37445.721	-71564.800	-10.399	-389398.052679
合計				158.970835
合計面積				79.4854175
地積				79.48 m <sup>2</sup>

地番	6 後退部			
N0	Xn	Yn	Yn+1-Yn-1	Xn · (Yn+1-Yn-1)
1593	37422.005	-71557.633	-1.000	-37422.005000
P6	37422.293	-71558.634	-1.005	-37609.404465
P5	37422.480	-71558.638	-0.014	-523.914720
BP4	37422.882	-71558.648	0.996	37273.190472
S5	37422.643	-71557.642	1.014	37946.560002
1594	37422.290	-71557.634	0.009	336.800610
合計				1.226899
合計面積				0.6134495
地積				0.61 m <sup>2</sup>

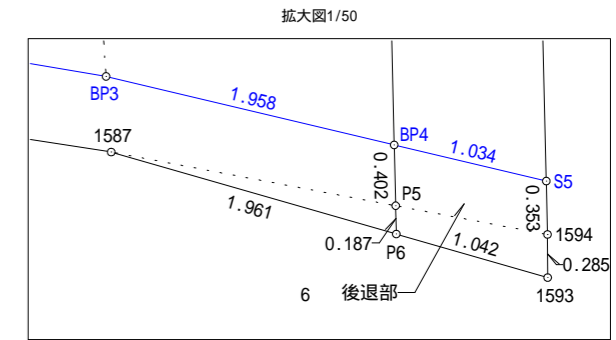
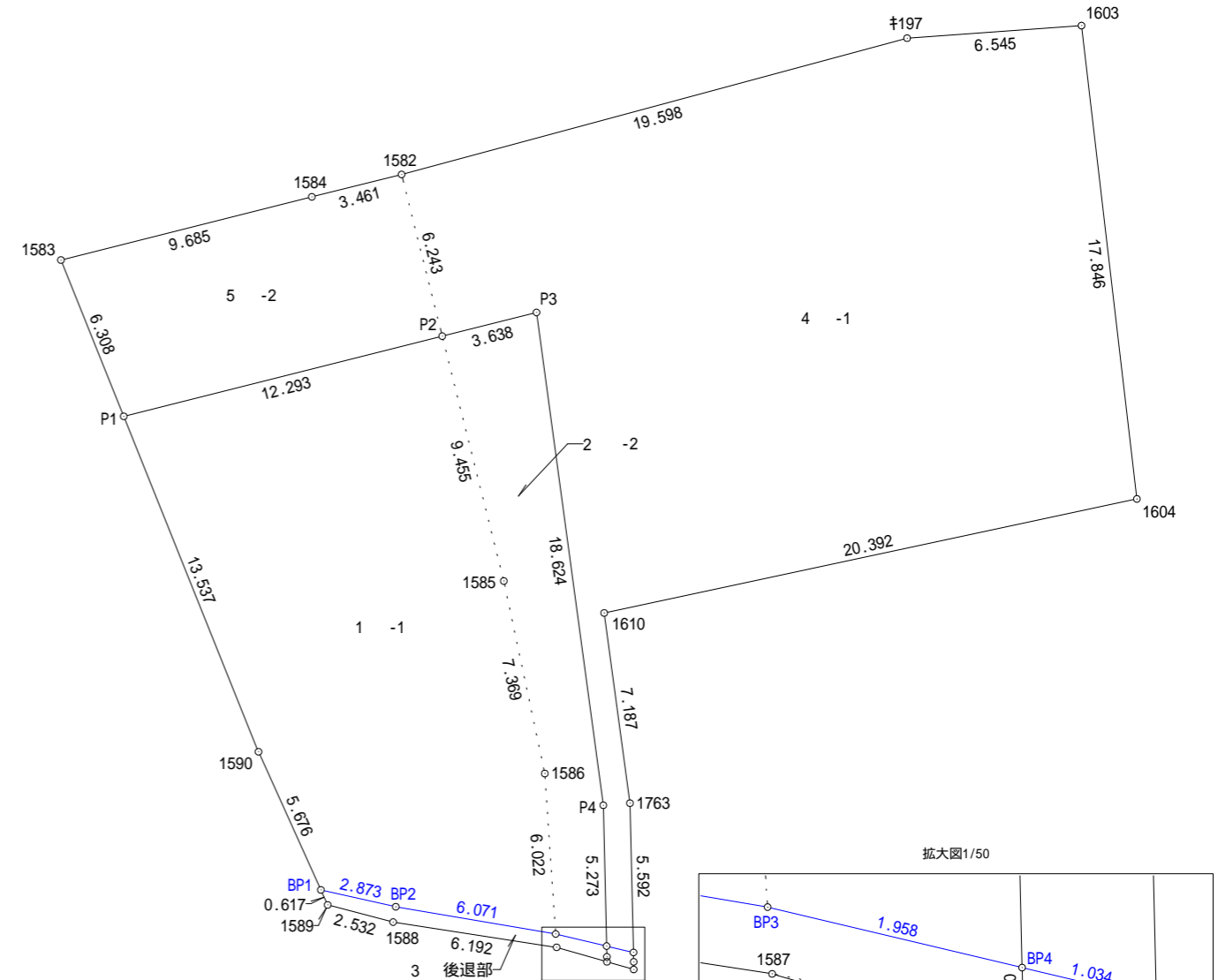

求積図	
所在	高崎市上大類町字道金田247番1外
縮尺	1/250
作成日	令和7年3月15日
作成者	土地家屋調査士 須長 亮